

BW Best Western **PLUS**
Hood River Inn

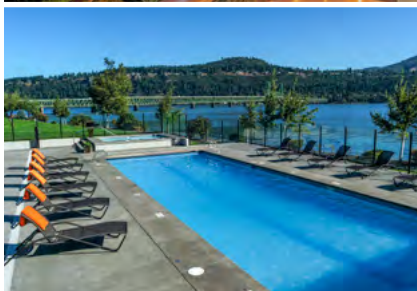

i n t h e h e a r t o f t h e c o l u m b i a r i v e r g o r g e





Location

The Best Western Plus Hood River Inn is located in the heart of the Columbia River Gorge, America's first National Scenic Area. Our location on the shores of the Columbia River just off I-84 at exit #64, is an easy and dramatically beautiful 60-minute drive from Portland.



Accommodations

The Inn offers 194 well-appointed guestrooms as well as one, two and three bedroom suites in a resort-like setting, many with river views and private balconies or patios. Our suites offer a variety of features from jetted tubs and gas fireplaces to full kitchens and large decks. All of our guestrooms have cable television with HBO, coffee makers, refrigerators, microwaves and more. Wireless internet is available throughout the Inn free of charge.

Dining and Entertainment

The Inn offers Hood River's only waterfront dining at our newly remodeled restaurant, Riverside. Enjoy Italian and American cuisine in a warm, contemporary atmosphere. Riverside's expansive floor to ceiling windows and outside deck allows you to enjoy Columbia River Gorge views while dining. Cebu Lounge offers casual dining and features a 25-foot mahogany bar and big screen TVs. Cebu's full bar features our award-winning wine list with an amazing selection of Northwest wines as well as 12 local and regional beers on tap.

Hotel Amenities

Our outdoor heated pool and spa feature panoramic views of the Columbia River. Our new fitness center features treadmill and elliptical machines with personal televisions, sauna and indoor spa, changing rooms and lockers. From our private beach area, a riverside path (perfect for strolling or running) connects the Inn with the rest of the Hood River waterfront, marina and downtown Hood River.

Local Attractions

The Hood River area offers one of the most complete outdoor playgrounds in the world. Hiking, windsurfing, kiteboarding, stand up paddle boarding, cycling, fishing, whitewater rafting, kayaking, golfing, skiing and snowboarding are among the myriad of activities available. For a less strenuous outing, visit our area's museums, tour the Fruit Loop, taste wine or craft beer or just enjoy the amazing beauty of the Gorge.

Services

The Best Western Plus Hood River Inn offers ample complimentary parking. Starbucks, McDonald's, convenience stores and two service stations are adjacent to the Inn. The Hood River County Visitor's Center is located just two blocks away and can be reached by our riverfront walking path. Our staff, many of whom have been at the Inn for over two decades, are eager to offer you assistance whenever possible.

Meeting Expectations? Exceeding Expectations!

The Best Western Plus Hood River Inn can comfortably accommodate groups up to 400. We offer seven meeting rooms totaling 12,000 square feet of space perfect for gala events, large conferences or smaller board meetings.



Hood River Inn

1108 E. Marina Way, Hood River, OR 97031
(541) 386-2200 fax (541) 386-7295

www.hoodriverinn.com • 1-800-828-7873



THE GORGE ROOM



Not your average meeting room! The Gorge Room is a free-standing building with vaulted ceiling and walls of glass. Located just steps from the lobby, it is one of the largest and most popular spaces in Hood River. When planning a meeting, meal, glittering gala, reception or themed event for up to 400 people, this is the space for you. As with all of our meeting spaces, our catering and meeting planning staff can help create a one of a kind event for any occasion.

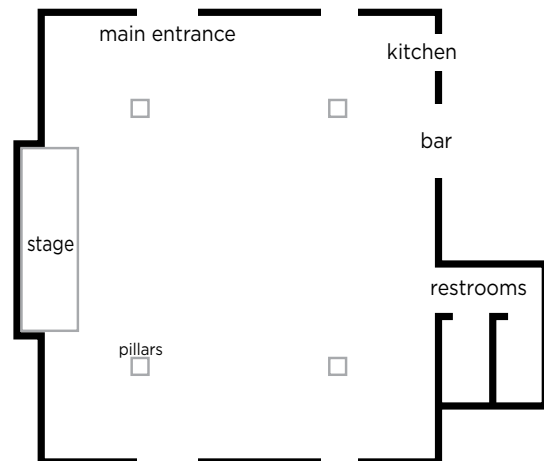

Theater Receptions	Class Room	Meal Functions	Square Feet	Dimensions
400	200	300	4400	67'x 66'





COLUMBIA ROOM



Theater Receptions	Class Room	U-Shape	Meal Functions	Square Feet	Dimensions
250	150	50	250	3250	61'x46'

The Columbia Room is our second largest room and is located up a wide staircase with access directly from of the lobby (wheelchair elevator access is available as well). The mezzanine entrance is perfect for your registration area. Windows in the back let in natural light and area artwork brightens the space nicely. This room can comfortably accommodate social groups or events for up to 250 people. It's central location allows for quick access to other hotel amenities and guest rooms.

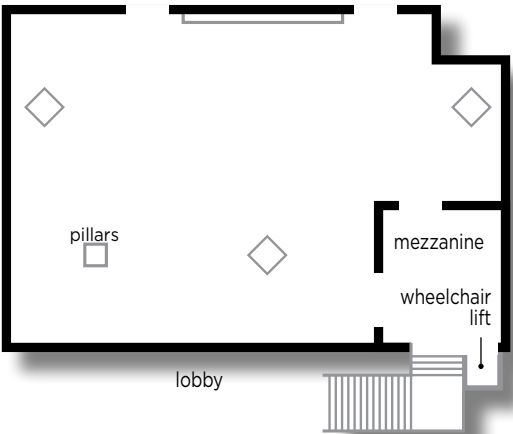



RIVERVIEW ROOM

The Riverview Room is a great option if you are interested in spectacular views! This room is located in the West Wing and offers two balconies so guests can enjoy uninterrupted sights of the Columbia River, Hood River Bridge and the surrounding bluffs. This is an excellent room for mid-size groups or a breakout room for larger conferences. Perfect for meetings or banquet meals, it can seat up to 80 people.



Theater Receptions	U-Shape	Conf. Style	Meal Functions	Square Feet	Dimensions
100	45	40	80	1250	25'x49'

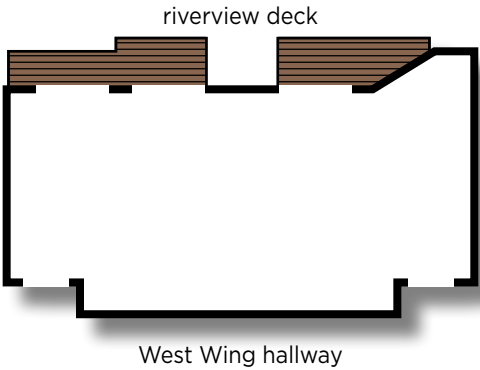



SHORELINE ROOM, DECK & PATIO



Shoreline is a semi-private area adjacent to Riverside. With a full-service bar and access to an expansive deck and patio overlooking the Columbia River, this room can accommodate up to 64 people for reception or meal functions inside, with seating for an additional 75 people on the outdoor deck.

Theater Receptions	U-Shape	Meal Functions	Square Feet	Dimensions
75	28	80	1000	25'x40'

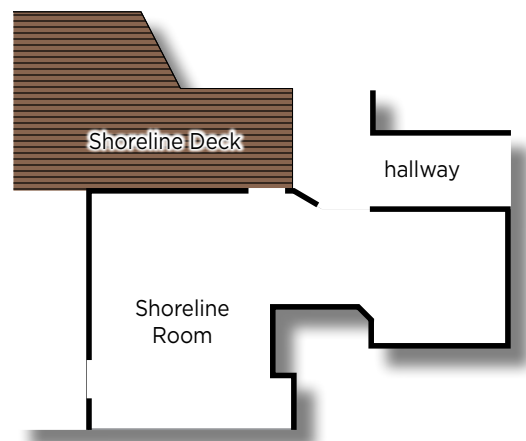



MOUNTAINVIEW ROOM

The Mountainview Room is also located in the Inn's West Wing across the hall from the Riverview Room. Expansive windows across the south facing side provide plenty of natural lighting. The room is convenient to the elevator and restrooms, and is just inside the West Wing entrance to the Inn. Both Mountainview and Riverview are easily served by Riverside's main kitchen and Cebu Lounge. The Mountainview Room offers groups of up to 60 people an ideal meeting or dining climate.

West Wing hallway

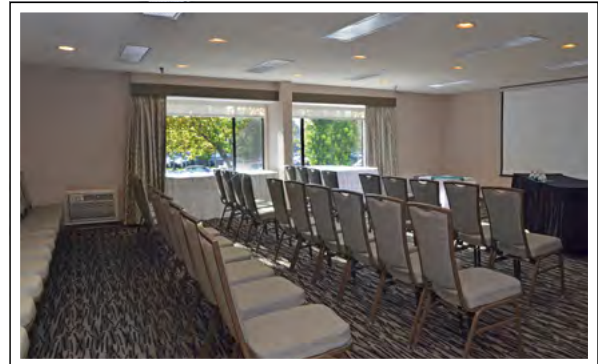
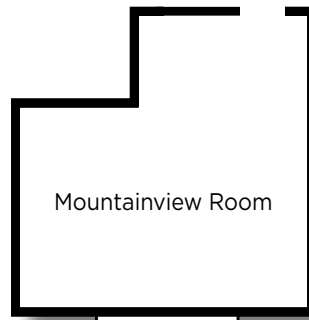

Theater Receptions	Class Room	Conf. Style	Meal Functions	Square Feet	Dimensions
65	30	30	40	800	28'x29'

MT HOOD & MT ADAMS ROOMS

The Mt. Adams and Mt. Hood Rooms are ideal for concurrent sessions along with the Columbia Room as they are located on the same level directly in front of the room. They are also accessible via stairs through Riverside restaurant. Individually, each room seats up to 35 people for meals and meeting functions. They also feature built in flat screen TVs.



Theater Receptions	Class Room	Conf. Style	Meal Functions	Square Feet	Dimensions
35	20	20	24	375	25'x16'
35	20	20	24	375	25'x16'

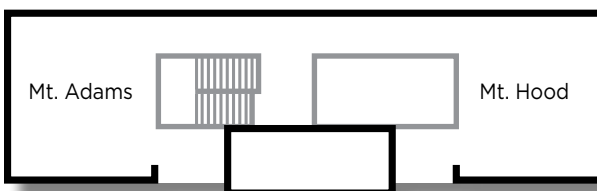

Hood River Inn



Best
Western
PLUS.

Hood River Inn

1108 E. Marina Way, Hood River, OR 97031 • p: 541-386-8901 f: 541-386-7295 Reservations: **800-828-7873** • www.hoodriverinn.com

